

POMPE DOPPIO STADIO A PALETTE LUBRIFICATE

Double stage oil lubricated rotary vane pumps

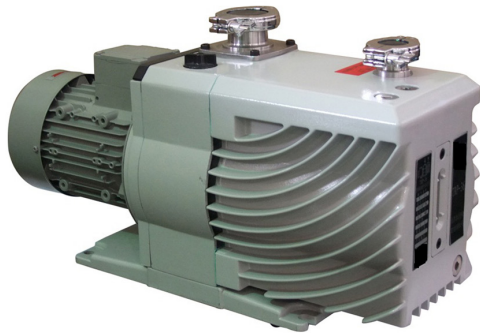

EVD-36

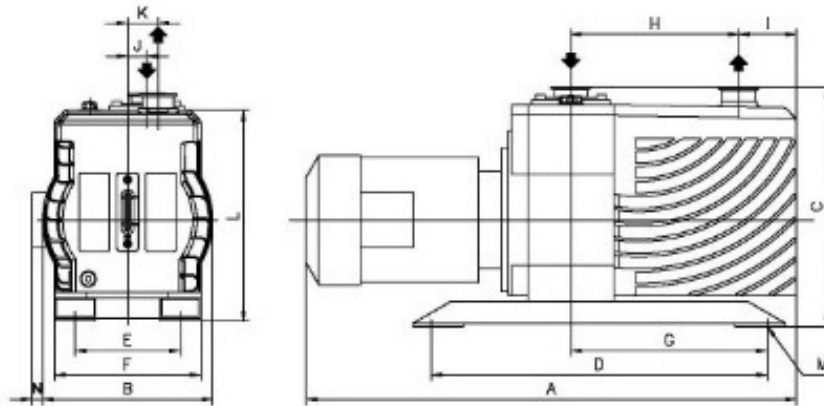

DATI TECNICI / Technical Data	50 Hz	60 Hz
Portata nominale / Nominal displacement		
Tensione motore trifase / Motor tension (3-Ph)	220 V/380 V	
Tensione motore monofase / Motor tension (1-Ph)		
Potenza motore trifase / Motor power (3-Ph)	0.75 kW	0.75 kW
Potenza motore monofase / Motor power (1-Ph)		
Vuoto finale senza gas ballast / Ultimate pressure without gas ballast		
Vuoto parziale / Disperse pressure	4x10 ⁻² Pa	4x10 ⁻² Pa
Vuoto totale / Whole pressure	4x10 ⁻¹ Pa	4x10 ⁻¹ Pa
Vuoto finale con gas ballast / Ultimate pressure with gas ballast		
Vuoto parziale / Disperse pressure	1.3 Pa	1.3 Pa
Vuoto totale / Whole pressure	4 Pa	4 Pa
Tolleranza massima vapore acqueo / Water vapour tolerance max	3300 Pa	3300 Pa
Connessione aspirazione / Inlet port		
Connessione scarico / Outlet port	DN25KF	DN25KF
Giri motore / Motor speed	1450 rpm	1750 rpm
Rumorosità / Sound level	52 dB(A)	52 dB(A)
Carica olio / Oil filling	1.8 liter	1.8 liter
Peso / Weight	39 kg	39 kg

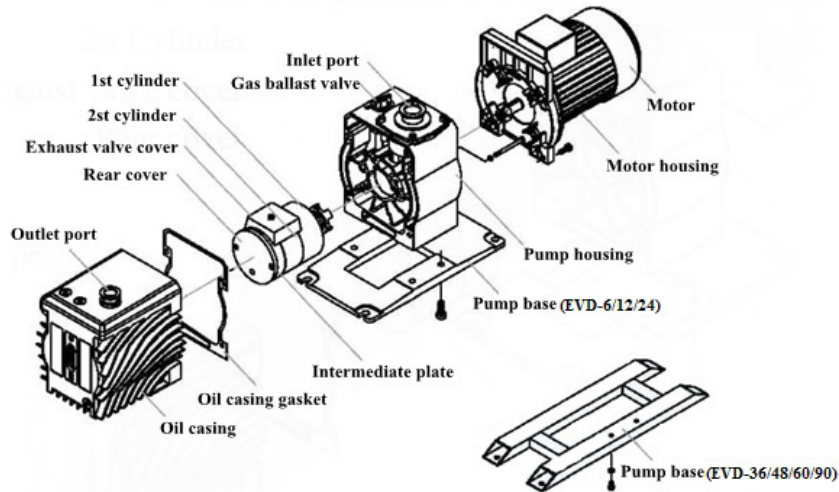
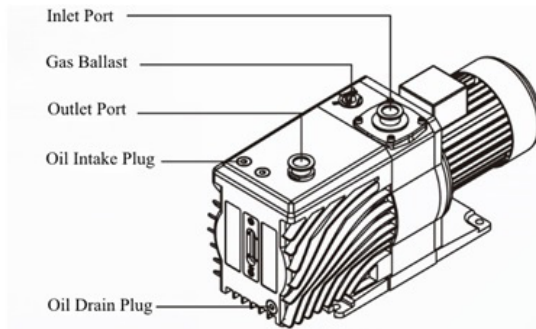

Pumping speed L/S

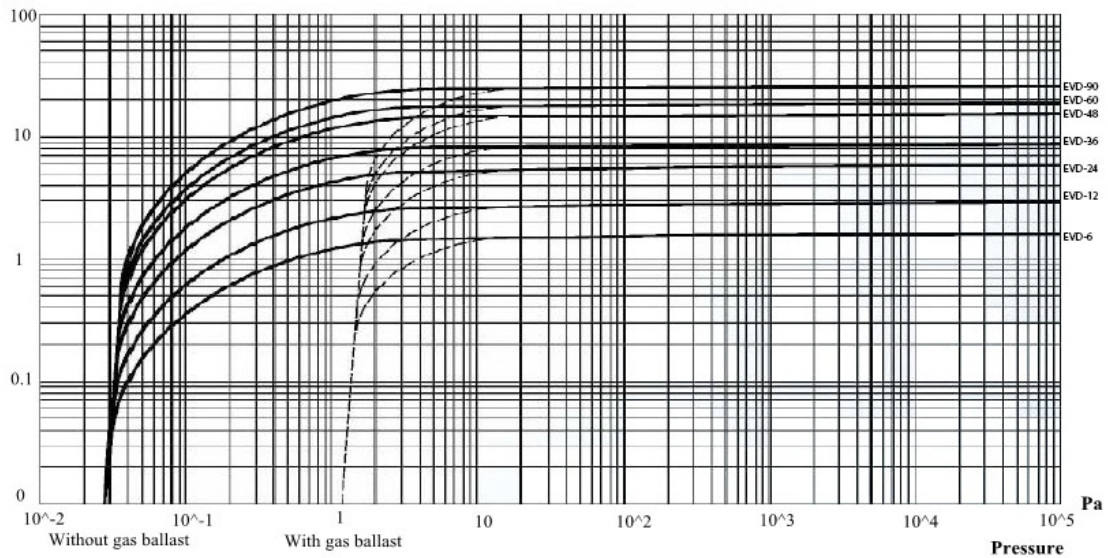

MODELLO Model	A	B	C	D	E	F	G	H	I	J	K	L	M	N
EVD-36	565	205	288/ 296	310	140	180	147	186	75	40	34	262	Ø12	48/0